

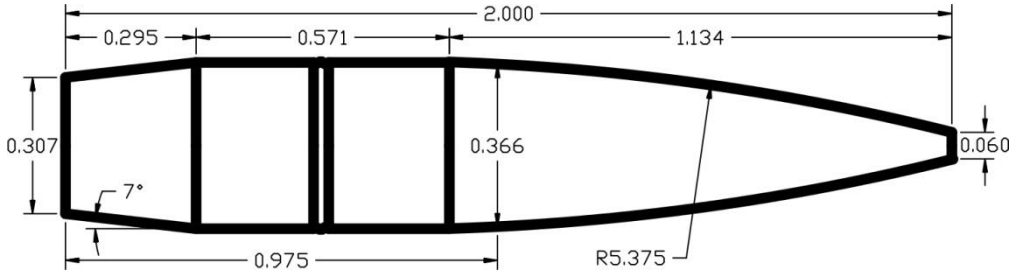

## Cutting Edge 375 caliber 352 grain MTAC



Lot #:	Unknown	Ogive Radius:	14.33 calibers
Sectional Density:	0.358 lb/in <sup>2</sup>	Rt/R:	0.77

### Ballistic Performance

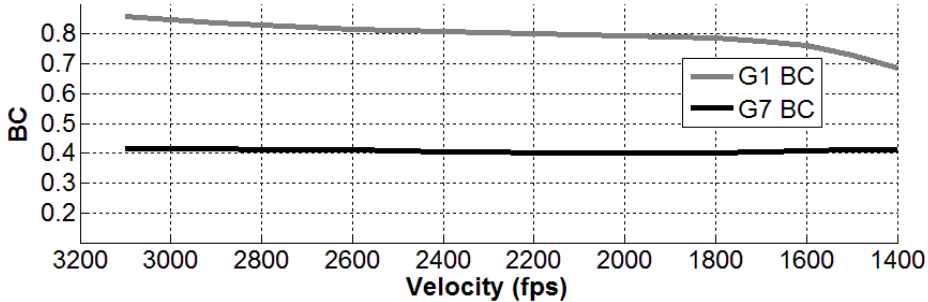

	Above 3000	3000-2500	2500-2000	2000-1500	Below 1500
<b>G1 BC</b>	0.877	0.830	0.803	0.762	0.730
<b>G7 BC</b>	0.415	0.411	0.404	0.405	0.411

Averages from 3000 fps to 1500 fps:

G1 BC: 0.796, variation of G1 BC: 0.118

**G7 BC: 0.408**, variation of G7 BC: 0.015

**G7 form factor: 0.876**

### Rifling Twist Rate and Stability

Barrel Twist	Stability Factor		
	Best case	Nominal	Worst Case
1:10"	2.05	1.79	1.55
1:11"	1.70	1.48	1.28
1:12"	1.43	1.25	1.08
1:13"	1.21	1.06	0.92

Minimum twist required for stability is 1:12.2"

Recommended twist for optimal performance is 1:10.9" or faster